

# THE ULTIMATE SURVEY BOT V2.0!

MAKING \$\$\$ HAS NEVER BEEN THIS EASY!

## Operating Manual

Release Version 2.3.0

**Legal Notice:** No part of this manual may be reproduced or transmitted in any form whatsoever. This includes but is not limited to electronic, mechanical, photocopying, recording, or by any informational storage or retrieval system without expressed written, dated and signed permission from a verified member of Bots4U™.

**Responsibility Notice:** While we always strive to make our software as incognito as possible... the use of said software may not be in complete compliance with the terms and conditions of every network you use it with, we here at Bots4U™ can take **NO** responsibility for the longevity of your account(s) when using them with our software.

**REMEMBER: USE AT YOUR OWN RISK!**

**Support Notice:** As a valuable user of our software we consider it a responsibility, for us as a team, to help you achieve your computing goals! If for any reason you need assistance with the setup or use of your software...

**Please don't hesitate to contact us!**

Email: [Support@Ultimatesurveybot.com](mailto:Support@Ultimatesurveybot.com)

Skype: Bots.4U

# WAKING UP COBY 2.0

## Starting Your Software:

To open the application, start by double clicking on the .EXE file included with this manual. Once open you will then be presented with the login panel. Here you can view the current queue and other helpful stats before logging in.

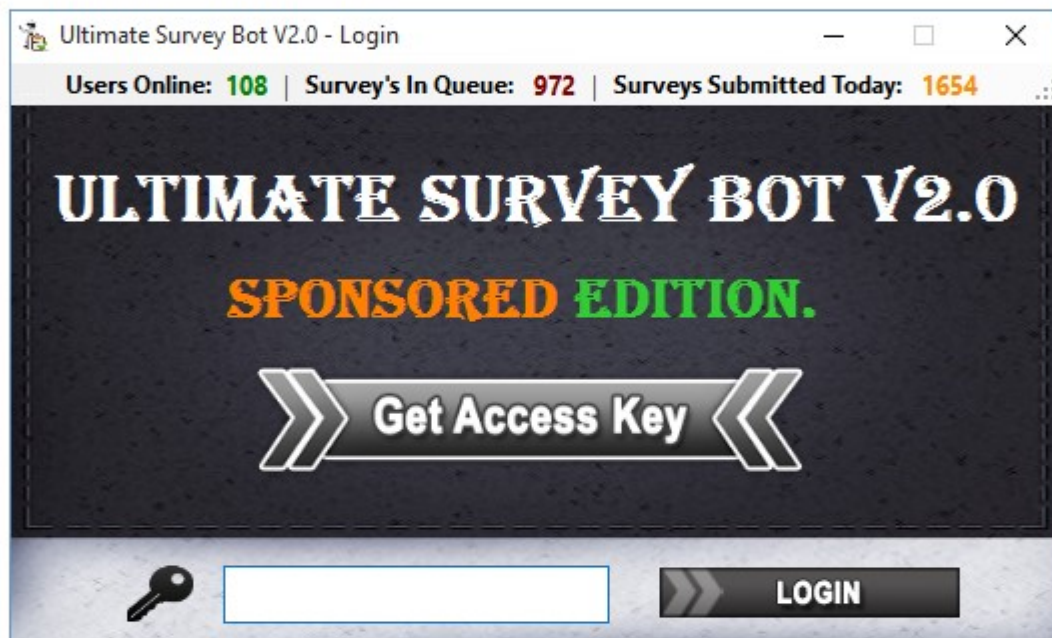

If at this point you do not have a working access key. You may click on the “Get Access Key” arrow/button and follow the steps on the next page in order to acquire one.

Once you have acquired your access key, enter it into the box and click LOGIN. You will then be taken to the main Control Panel where you will be able to view your session details and continue on your botting journey...

**NOTICE:** Since the access key system helps provide for the entire COBY 2.0 community as a whole. The sharing of your access key across the web is prohibited! And will continue to be punishable by a lifetime ban from our entire network & tools.



# SETTING UP COBY 2.0

## Critique Your Settings:

To view your settings panel click on the "My Settings" tab.

My Statistics   My Settings   Add Surveys!   Survey Exchange!

**Basic Settings:**

- ☐ Free Proxy List: (Quality Poor)
- ☐ Free Captcha Bot (Success Rate: 30%)

**\*\*\* Premium Settings \*\*\***

- ☐ **NEW!** Undetectable Mode! (HumanLike AI + HQ VPN)
- ☐ **BETA TESTING!** Real Information Generator!
- ☐ Premium Captcha Bot (Success Rate: 80%)

**Notice:** While enabling these settings could very well help raise the success rate of completion... every setting is optional and isn't required to start COBY 2.0.

We have worked tirelessly to make our settings as simple as possible... thus settings have been split into two main categories...

## BASIC SETTINGS

### Free Proxy List: (Quality Poor)

As the name implies, when enabled the console will attempt to connect using a proxy server selected from our current stock pile instead of using the hosts address.

**Notice:** Unless disabled this feature is left on by default.

## Free Captcha Bot (Success Rate: 30%)

When enabled, if the server's element scanner comes across a Captcha, instead of dropping an error, it will attempt to solve it using our extensive library of cataloged Captcha Images up to that point.

## ☆☆☆ PREMIUM SETTINGS ☆☆☆

### NEW! Undetectable Mode! (HumanLike AI + HQ VPN) & Real Information Generator!

As the names suggest, these two gems are currently our flagship settings. With a dedicated VPN, HumanLike delayed form input and redesigned algorithms to prevent detection and filter blocking, these settings will definitely help improve your SR!

### Premium Captcha Bot (Success Rate: 80%)

An upgraded version of our free Captcha Bot... includes an increased problem solving algorithm and a much larger image library.

## FEEDING COBY 2.0

### Submitting Your Surveys:

To add a survey click on the "Add Surveys!" tab to view the systems queue adder.

My Statistics

My Settings

Add Surveys!

Survey Exchange!

**Add Survey To Queue:**

http:// +

Add Link

**Select A Supported Platform:**

RevenueUniverse

OfferToro | www.offertoro.com/click\_track/track/71966/44

OfferToro | www.offertoro.com/click\_track/track/5461/446

OfferToro | www.offertoro.com/click\_track/track/838/446/

Persona.ly | persona.ly/widget/offer?appid=9274099f74d93

Persona.ly | persona.ly/widget/offer?appid=9274099f74d93

Persona.ly | persona.ly/widget/offer?appid=9274099f74d93

RevenueUniverse | publishers.revenueuniverse.com/click



**IMPORTANT:** As we cannot guarantee our system will be able to use your logged in cookie session to access the survey... please only enter DIRECT access URL's into the queue since these types of links can be accessed without being logged into your account and already have your accounts unique GET variables attached to them.

**GOOD URL! ✓**

[www.platform.com/click.php?affiliate=1587&campaign=5829&sid=SFB\\_105\\_&sid2=3375457&app=105](http://www.platform.com/click.php?affiliate=1587&campaign=5829&sid=SFB_105_&sid2=3375457&app=105)

**BAD URL! X**

[www.GPT.com/go/56264/3375457](http://www.GPT.com/go/56264/3375457)

As a general rule you can find most of the direct survey URLs in OfferWalls by right clicking on a survey and then selecting: "Copy Link Location"

The screenshot shows the OfferWalls website interface. At the top, there's a navigation bar with 'Earn', 'Rewards', 'Win', and 'Invite' buttons. The user's level is 'Platinum' with '24810 Points'. The user's name is 'Scott'. Below the navigation bar, there are several survey offers. The first offer is 'Become a JustFab VIP' with a reward of '1,500 Points'. The second offer is 'Take a Super Survey' with a reward of '60 Points'. The third offer is 'GameFly' with a reward of '95 Points'. The fourth offer is 'Athletic Greens' with a reward of '1,500 Points'. A right-click context menu is open over the 'GameFly' offer, showing options like 'Open Link in New Tab', 'Open Link in New Window', 'Open Link in New Private Window', 'Bookmark This Link', 'Save Link As...', 'Copy Link Location', 'Search Google for "60 Points"', 'This Frame', 'Inspect Element (Q)', 'Adblock Plus: Block frame...', and 'Adblock Plus: Block image...'. A red arrow points to the 'Copy Link Location' option.

# RUNNING COBY 2.0

## Submitting Your Request:

Once you have added your surveys to the queue and adjusted the settings to your liking. You can start COBY 2.0 by clicking on the “Start Bot!” master switch found on the bottom right hand corner of your control panel.

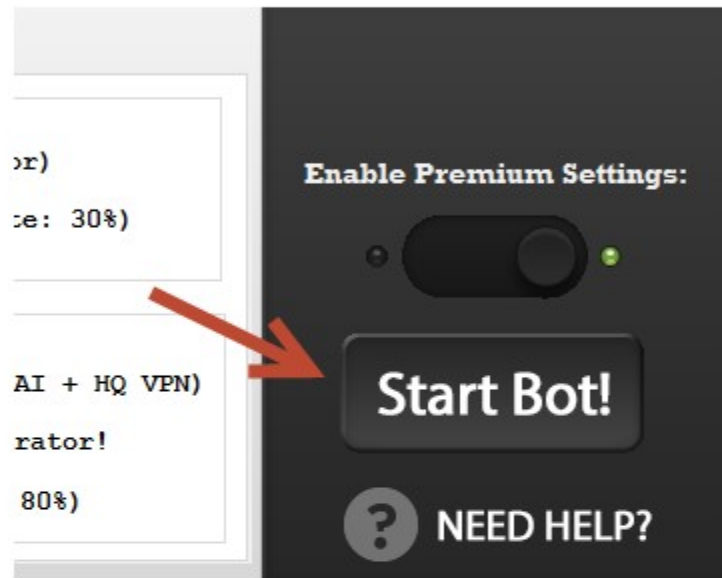

You will then be brought to the main console where you can view the status of your request with our new live progress feed! And all that will be left for you to do is relax, sit back, and enjoy the show!

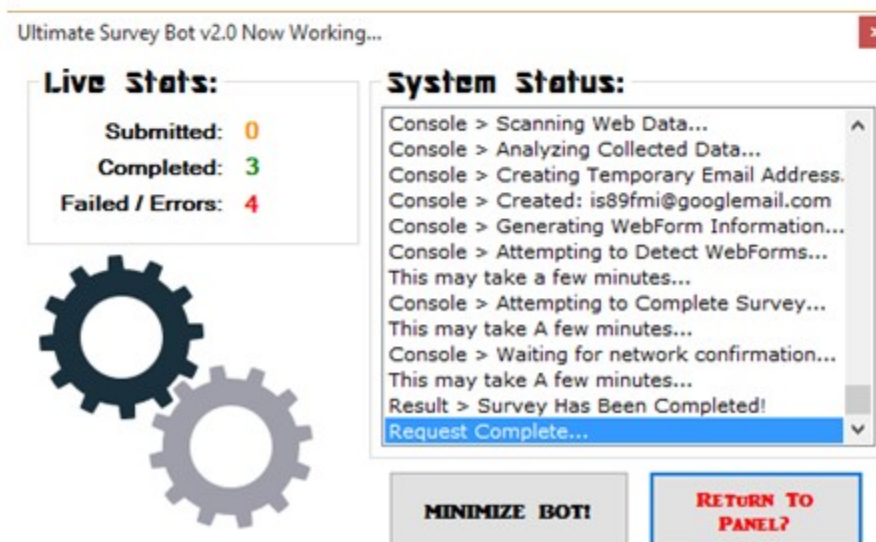



# NEW FEATURE! THE EXCHANGE!

## Exchanging Your Failures!

Being by far one of the most requested features... we just couldn't keep putting it off any longer and we are proud to announce that we have finally added it!

[My Statistics](#) [My Settings](#) [Add Surveys!](#) [Survey Exchange!](#)

**LIVE! Surveys Awaiting Exchange:**

Failures This Session: **1** Exchanged: **0**

48500	OfferToro	www.offertoro.com/click_track/track/5
48555	OfferToro	www.offertoro.com/click_track/track/7
48501	OfferToro	www.offertoro.com/click_track/track/8
48503	Persona.ly	persona.ly/widget/offer?appid=927409
48502	Persona.ly	persona.ly/widget/offer?appid=927409
48504	Persona.ly	persona.ly/widget/offer?appid=927409

[Exchange!](#) [Report This Link!](#) [Learn More!](#)

In an effort to allow users the ability to help give back to this amazing and growing community and also help to improve our algorithms! The Surveys Exchange will let you submit any or all of your current failed completions in for both re-analyses by our system and manual completion by other users. Provided of course that you complete someone else's failed completion yourself on a 1-1 ratio!

**REMEMBER: ATTEMPTING TO DEFILE THE SACRED TRUST OF OUR GENEROUS COMMUNITY WILL NOT GO UNPUNISHED!**

Trying to in any way abuse or fake an exchange will NOT be tolerated! Our system relies on a good faith policy in that you agree that you will complete the user's survey to the best of your ability in exchange for other users to do likewise with yours!

## **FINAL TIPS:**

While we have placed very few limitations on the number of surveys you can submit. To protect your account(s) we do not recommend you submit any more within a 24 time period then you think you would be able to manually complete on your own (15 or 30) a day is a good number to consider.

As a general rule, our system will be able to process your requests as soon as you submit them. But as more users begin using our system, it may become bogged down... to avoid this inconvenience, try using our software at night when the network wide usage and current queue waiting period is at its lowest point.

**Remember:** Since the continued success of our project is by keeping it somewhat under wraps... Please try and show a certain level of discretion when discussing our tools with your family and friends.

## **FAQ/TROUBLESHOOTING:**

**Q: I can't get COBY 2.0 to start!**

**A:** Before contacting us about this, please verify that you have an updated version of the .NET Framework 4.0+ as our tools require this to operate properly.

**Q: I keep getting errors!**

**A:** There may be times when errors occur. If you do get an error while using our tools please snag a screen shot of the error and send it to us immediately so we can rectify the issue as soon as possible.



**Q: Can your system do phone verification surveys (also known as PIN submits)?**

A: While we are continuing to learn about and add new methods of completion to the COBY 2.0 project and even recently included a temporary email creator... at this time tasks such as phone verification are not compatible with our system.

**Q: I was asked to complete a survey to use the bot! Why is this?**

A: As an alternative to charging for our software, we rely on you guys to help both support the Bots4U™ team and continue to improve our algorithms by completing surveys to unlock some of COBY's features. Thus increasing our systems overall knowledge of how to correctly complete more surveys every time you do so in exchange for access keys or premium pin codes... And in all truth we feel that the pros highly outweigh the cons in this particular case.

**Q: COBY 2.0 didn't complete all my surveys!**

A: This is partly because for the time being our algorithm is still learning a great deal about what it is being asked to do and while we are continually working toward improving COBY's success rate, along with the range of compatible offers he can complete... he isn't perfect.

It's also important to realize that even if our system completes and verifies a survey perfectly, many networks have systems in place to prevent this type of completion and may or may not grant you a credit even though it was technically "completed". For now it's really just the name of the game.

**Q: Why can't I see surveys completed live?**

A: One of the secrets of our system is that many requests are processed server side, instead of using a user sided dedicated browser. Allowing us to better control our resources and saving your computer from unneeded stress, allowing you to easily do other tasks instead of looking at a 95% CPU for 2 hours. However we have recently added an instantly updated progress feed so you can actually see what's happening on our side live!